

Copying of this document and giving it to others, and the use or communication of the contents thereof, are forbidden without express authority. All rights reserved.

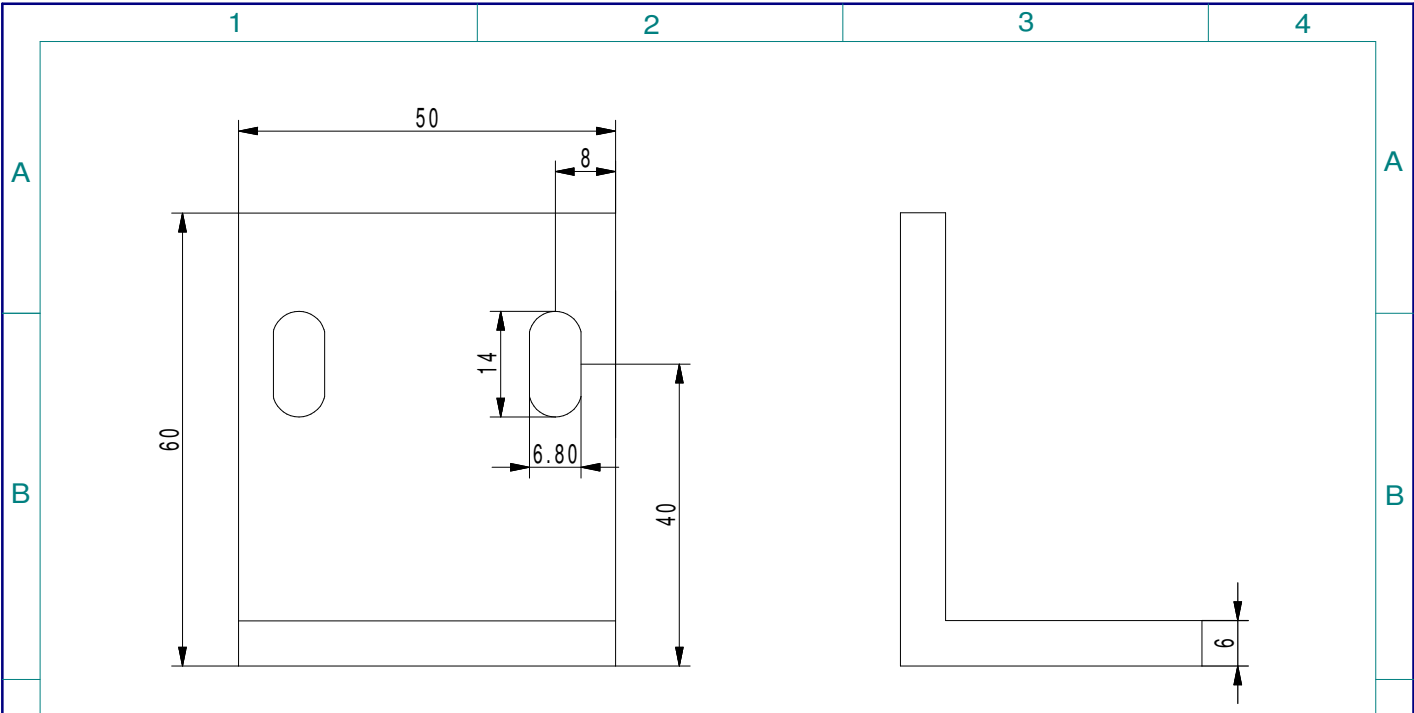

### Anwendungsbeispiel (Example of Application)

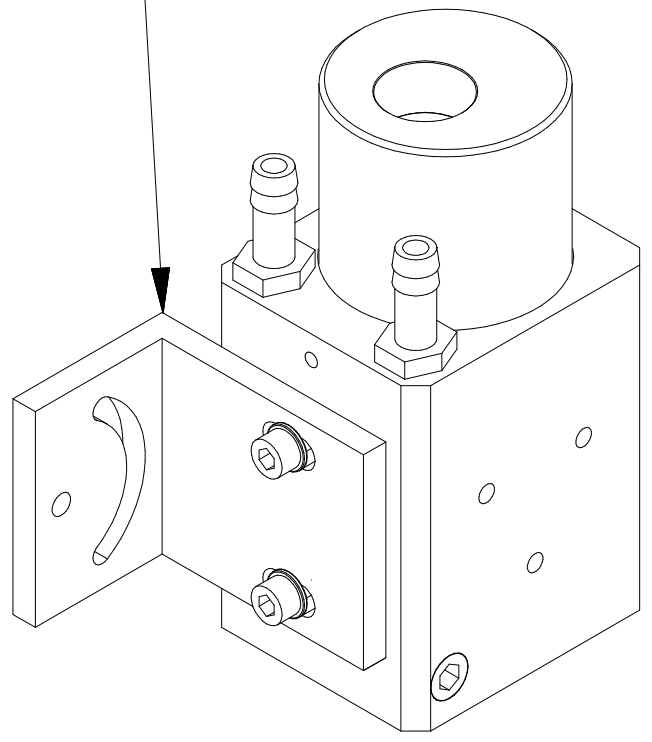
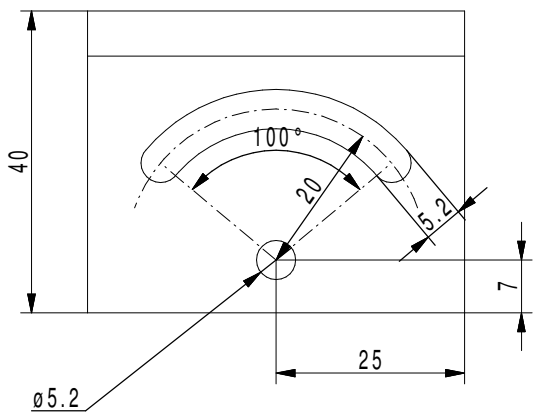

Weitergabe und Vervielfältigung dieser Unterlage, sowie Verwertung und Mitteilung ihres Inhalts nicht gestattet, soweit nicht ausdrücklich zugestanden. Alle Rechte vorbehalten

|                |                          |   |              |  |                  |                                     |                    |                                    |         |                          |  |
|----------------|--------------------------|---|--------------|--|------------------|-------------------------------------|--------------------|------------------------------------|---------|--------------------------|--|
|                |                          | Maße in mm<br>Dimensions in millimeters |              | Zul. Abw. f. Maße ohne Toleranzang.<br>General tolerances  |                  | Fertigzustand<br>finished condition |                    | Maßstab<br>Scale <b>1 : 1</b>      |         | Menge<br>Quantity .      |  |
|                |                          |   |              |  |                  |                                     |                    | Rohstoff/Raw material<br>Aluminium |         | Gewicht/Weight:<br>0,5Kg |  |
|                |                          |   |              | Benennung/Designation<br><b>HA10-10</b><br><b>Justierbarer Haltewinkel</b><br><b>Adjustable Mounting Bracket</b> |                  |                                     |                    |                                    |         | Blatt<br>Sheet <b>1</b>  |  |
|                |                          |   |              | Sachnummer/Part-No.<br><b>ZN012500</b>   |                  |                                     |                    |                                    |         | von<br>of <b>1</b>       |  |
| Ausg.<br>Issue | Anderung<br>Modification | Datum<br>Date                           | Name<br>Name | Dateiname<br>Filename  | Zu. Name<br>Name |                                     | Ursprung<br>Source |                                    | MegaCAD |                          |  |
|                |                          |   |              | ZN012500_HA10-10-Prt   | Husic Senad      |                                     |                    |                                    |         |                          |  |
|                |                          |   |              |  | Bearb.<br>Drawn  |                                     |                    |                                    |         |                          |  |
|                |                          |   |              |  | Gepr.<br>Checked |                                     |                    |                                    |         |                          |  |
|                |                          |   |              |  | Norm<br>Approved |                                     |                    |                                    |         |                          |  |
|                |                          |   |              |  | Datum<br>Date    |                                     |                    |                                    |         |                          |  |
|                |                          |   |              |  | Name<br>Name     |                                     |                    |                                    |         |                          |  |

